

Recommended PCB Layout
 Solder Area

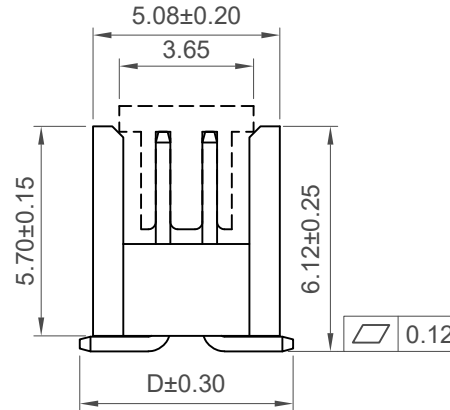
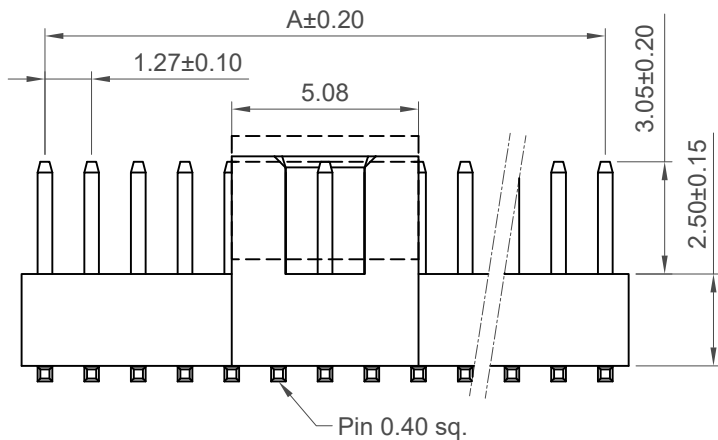
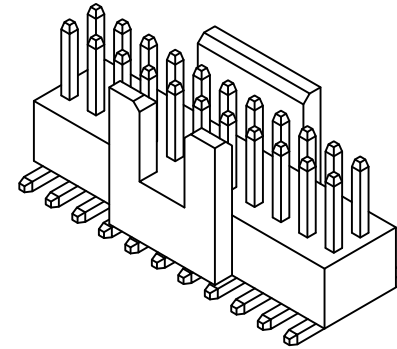

Specifications

Material

Insulator: LCP, UL 94V-0, Black
 Terminal: Brass

Plating

See Ordering Grid

Electrical

Current Rating: 1A per pin
 Contact Resistance: 20 mΩ max.
 Insulating Resistance: 1000 MΩ min.
 Dielectric Withstand Voltage: 500V AC

Soldering Process:

IR Reflow: 260°C for 10 sec.
 Manual Solder: 350°C for 3-5 sec

Mechanical & Environmental

Operating Temperature: -40°C to +105°C

Mates with (Subject to pin length)

BD050 BD055 BD060 BD064

No. of Contacts	Dimensions	
	A	B
8	3.81	5.08
* 10	5.08	6.35
12	6.35	7.62
14	7.62	8.89
* 16	8.89	10.16
18	10.16	11.43
* 20	11.43	12.70
22	12.70	13.97
24	13.97	15.24
* 26	15.24	16.51
28	16.51	17.78
* 30	17.78	19.05
32	19.05	20.32
* 34	20.32	21.59
36	21.59	22.86
38	22.86	24.13
* 40	24.13	25.40
42	25.40	26.67
44	26.67	27.94
46	27.94	29.21
48	29.21	30.48
* 50	30.48	31.75

* = Tooled Parts
 Please contact GCT for non-tooled parts

Ordering Grid: **BD125-XX-X-0305-XXXX-L-X**

No. of Contacts: 08 to 50

Contact Plating: A = Gold Flash All Over (Standard), C = Tin All Over, G = 10µ" Gold Contact Area/Tin On Tail

Packing Options: B = Tape & Reel with Cap (Standard), D = Tube, E = Tube with Cap

Insulator Material: L = LCP

Request Samples and Quotation

Dimension D (1/100mm) (Width of Footprint)
0580 = 5.80mm (Standard)
 or specify Custom Footprint Width
 e.g. 5.50mm = 0550

Part Number		Product Description	
BD125		1.27mm Pitch Pin Header, Dual Row, Surface Mount, Vertical	
Drawing Date		18th November 2022	
By	CC	Tolerances (Except as Noted)	Units:
Detail	Drawing Release	Length	Metric (mm)
Revision	A	Angle	
Date	18/11/22	X.X ± 0.30	
		X.XX ± 0.20	



This drawing is confidential and copyright of Global Connector Technology, Ltd (GCT). This drawing must not be copied or disclosed without written consent. E & OE



Not to Scale	Drawn By CC	Sheet No. 1/1
--------------	-------------	---------------