

**Recommended PCB Layout**

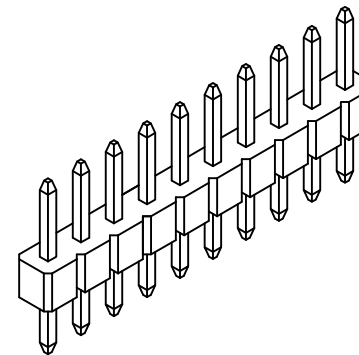
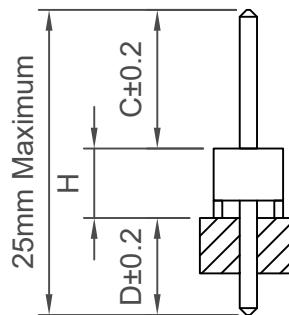
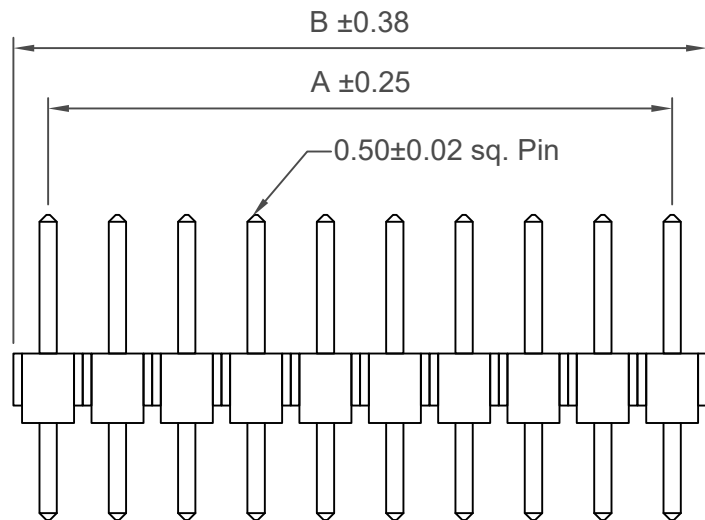

No. of Contacts	Dimensions	
	A	B
2	2.0	4.0
3	4.0	6.0
4	6.0	8.0
5	8.0	10.0
6	10.0	12.0
7	12.0	14.0
8	14.0	16.0
9	16.0	18.0
10	18.0	20.0
11	20.0	22.0
12	22.0	24.0
13	24.0	26.0
14	26.0	28.0
15	28.0	30.0
16	30.0	32.0
17	32.0	34.0
18	34.0	36.0
19	36.0	38.0
20	38.0	40.0

No. of Contacts	Dimensions	
	A	B
21	40.0	42.0
22	42.0	44.0
23	44.0	46.0
24	46.0	48.0
25	48.0	50.0
26	50.0	52.0
27	52.0	54.0
28	54.0	56.0
29	56.0	58.0
30	58.0	60.0
31	60.0	62.0
32	62.0	64.0
33	64.0	66.0
34	66.0	68.0
35	68.0	70.0
36	70.0	72.0
37	72.0	74.0
38	74.0	76.0
39	76.0	78.0
40	78.0	80.0

**Specifications**

**Material**

Insulator material:  
 Standard  
 Polyamide, Nylon 6T, UL 94V-0  
 Options:  
 Polymer, LCP, UL 94V-0  
 Polyester, PBT, UL 94V-0  
 Contact Terminal : Copper Alloy

**Plating**

See Ordering Grid

**Electrical**

Current Rating: 2 Amp per pin  
 Contact Resistance: 20 mΩ max.  
 Insulation Resistance: 1000 MΩ min.  
 Dielectric Withstand Voltage: 500 V AC

**Mechanical & Environmental**

Operating Temperature: -40°C to +105°C

**Soldering process:**

Nylon 6T (Standard) -  
 IR Reflow: 260°C for 10 sec.  
 Wave: 230°C for 5-10 sec.  
 Manual solder: 350°C for 3-5 sec

**LCP (Option) -**

IR Reflow: 260°C for 10 sec.  
 Wave: 250°C for 5-10 sec.  
 Manual solder: 350°C for 3-5 sec

**PBT (Option) -**

Manual Solder: 330°C for 3-5 sec  
 (Not Suitable for High Temperature Process)

**Mates with (subject to pin length):**

BF070 BF085 BF086 BF087 BF088 BF090

BF085 Recommended mating length 3.00mm

**Contact Plating**

**A = Gold Flash All Over (Standard)**  
**B = Selective Gold Flash Contact Area/Tin On Tail**  
**C = Tin All Over**  
**G = 10µ" Gold Contact Area/Tin On Tail**  
**I = 30µ" Gold Contact Area/Tin On Tail**  
**L = Matte Tin**

**Insulator Height 'H'**

**B = 2.00mm (Standard)**  
**A = 1.50mm**

**Ordering Grid**

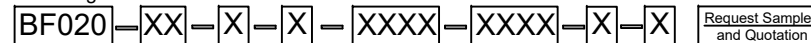

No. of Contacts  
02 to 40

Request Samples and Quotation

**Packing Options**

**G = Plastic Box (Standard)**  
**D = Tube**  
**E = Tube with Cap**

**Insulator Material**

**N = Nylon 6T (Standard)**  
**P = PBT**  
**L = LCP**

**Dimension D (1/100mm) (Tail Length)**

**0300 = 3.00mm (Standard)**  
 Or specify Custom Tail Length  
 e.g. 2.50mm = 0250  
 (Maximum 1500 = 15.00mm)  
 (Minimum 0050 = 0.50mm)

**Dimension C (1/100mm) (Post Height)**

**0300 = 3.00mm (Standard)**  
**0400 = 4.00mm (Standard)**  
**0600 = 6.00mm (Standard)**  
 Or specify Custom Post Height  
 eg 0250 = 2.50mm  
 (Maximum 1500 = 15.00mm)  
 (Minimum 0050 = 0.50mm)

Part Number		Product Description	
BF020		2.00mm Pitch Pin Header	
Drawing Date		Single Row, Through Hole, Vertical	
25th October 2007			
By	CC	Tolerances (Except as Noted)	Units:
Detail	BF020 D PCN	Length: X. ± 0.30 D: XX ± 0.20	Metric (mm)
Revision	D4	Angle: X.X° ± 5° X.XX° ± 2° X.XXX° ± 1°	3rd Angle Projection
Date	17/03/22	X.XXX ± 0.10 X.XXX* ± 0.5*	



This drawing is confidential and copyright of Global Connector Technology, Ltd (GCT). This drawing must not be copied or disclosed without written consent. E & OE



www.gct.co

Not to Scale	Drawn By LYH	Sheet No. 1/1
--------------	--------------	---------------