

H  
G  
F  
E  
D  
C  
B  
A

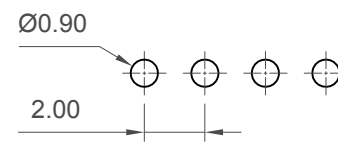

**Recommended PCB Layout**

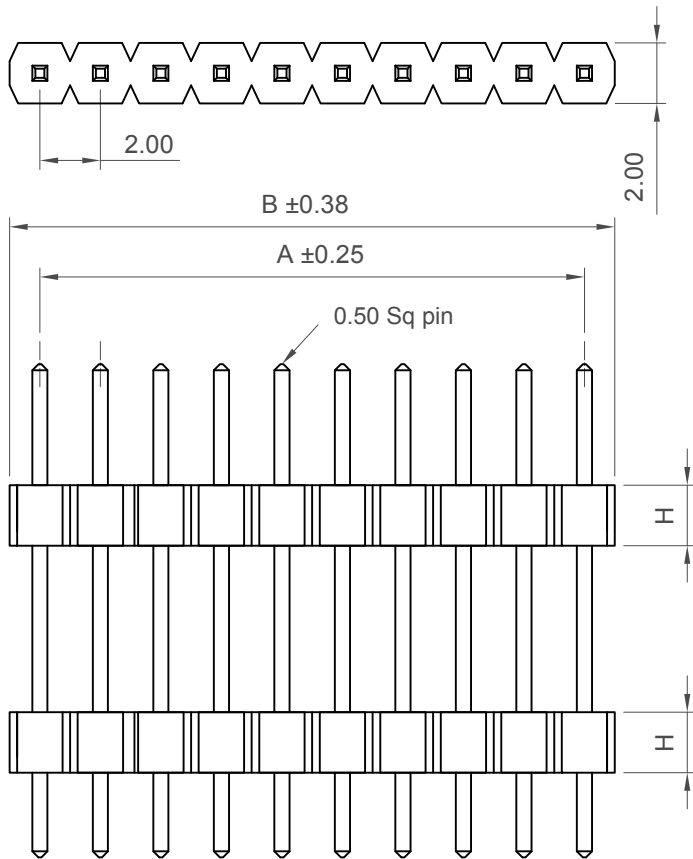
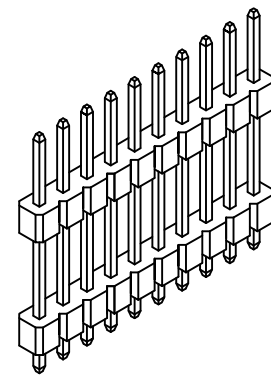
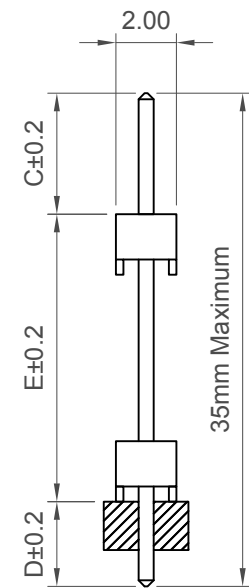

No. of Contacts	Dimensions	
	A	B
2	2.0	4.0
3	4.0	6.0
4	6.0	8.0
5	8.0	10.0
6	10.0	12.0
7	12.0	14.0
8	14.0	16.0
9	16.0	18.0
10	18.0	20.0
11	20.0	22.0
12	22.0	24.0
13	24.0	26.0
14	26.0	28.0
15	28.0	30.0
16	30.0	32.0
17	32.0	34.0
18	34.0	36.0
19	36.0	38.0
20	38.0	40.0

No. of Contacts	Dimensions	
	A	B
21	40.0	42.0
22	42.0	44.0
23	44.0	46.0
24	46.0	48.0
25	48.0	50.0
26	50.0	52.0
27	52.0	54.0
28	54.0	56.0
29	56.0	58.0
30	58.0	60.0
31	60.0	62.0
32	62.0	64.0
33	64.0	66.0
34	66.0	68.0
35	68.0	70.0
36	70.0	72.0
37	72.0	74.0
38	74.0	76.0
39	76.0	78.0
40	78.0	80.0

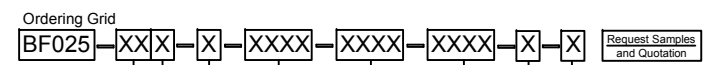

No. of Contacts: 02 to 40  
 Insulator Material: N = Nylon 6T (Standard), P = PBT, L = LCP  
 Packing Options: G = Plastic Box (Standard), D = Tube, E = Tube with Cap

**Contact Plating**  
 A = Gold Flash All Over (Standard)  
 B = Selective Gold Flash Contact Area/Tin On Tail  
 C = Tin All Over  
 G = 10µ" Gold Contact Area/Tin On Tail  
 I = 30µ" Gold Contact Area/Tin On Tail

**Insulator Height "H"**  
 B = 2.00mm (Standard)  
 A = 1.50mm

**Dimension C (1/100mm) (Post Height)**  
 0300 = 3.00mm (Standard)  
 0400 = 4.00mm (Standard)  
 Or specify Custom Post Height eg. 0250 = 2.50mm (Maximum 0800 = 8.00mm) (Minimum 0050 = 0.50mm)

**Dimension E (1/100mm) (Stack Height)**  
 0800 = 8.00mm (Standard)  
 Or specify Custom Tail Length eg. 0450 = 4.50mm (Maximum 2000 = 20.00mm) (Minimum 2x "H")

**Dimension D (1/100mm) (Tail Length)**  
 0300 = 3.00mm (Standard)  
 Or specify Custom Tail Length eg. 0280 = 2.80mm (Maximum 0800 = 8.00mm) (Minimum 0050 = 0.50mm)

**Specifications**

**Material**  
 Insulator material: Standard  
 Polyamide, Nylon 6T, UL 94V-0  
 Options: Polymer, LCP, UL 94V-0  
 Polyester, PBT, UL 94V-0  
 Contact Terminal : Copper Alloy

**Plating**  
 See Ordering Grid

**Electrical**  
 Current Rating: 2 Amp per pin  
 Contact Resistance: 20 mΩ max.  
 Insulation Resistance: 1000 MΩ min.  
 Dielectric Withstand Voltage: 500 V AC

**Soldering process:**  
 Nylon 6T (Standard) -  
 IR Reflow: 260°C for 10 sec.  
 Wave: 230°C for 5-10 sec.  
 Manual solder: 350°C for 3-5 sec

**LCP (Option) -**  
 IR Reflow: 260°C for 10 sec.  
 Wave: 250°C for 5-10 sec.  
 Manual solder: 350°C for 3-5 sec

**PBT (Option) -**  
 Manual Solder: 330°C for 3-5 sec  
 (Not Suitable for High Temperature Process)

**Mates with (subject to pin length):**  
 BF070 BF085 BF086 BF087 BF088 BF090

BF085 Recommended mating length 3.00mm

**Mechanical & Environmental**  
 Operating Temperature: -40°C to +105°C

Part Number		Product Description	
BF025		2.00mm Pitch Elevated Pin Header	
Drawing Date		Single Row, Through Hole, Straight	
25th October 2007			
By	CC	Tolerances (Except as Noted)	Units:
Detail	BF025 C PCN	Length X. ± 0.30 X.X ± 0.20 X.XX ± 0.15 X.XXX ± 0.10	Metric (mm)
Revision	C3	Angle X° ± 5° X.X° ± 2° X.XX° ± 1° X.XXX° ± 0.5°	3rd Angle Projection
Date	11/09/17		



This drawing is confidential and copyright of Global Connector Technology, Ltd (GCT). This drawing must not be copied or disclosed without written consent. E & OE



Not to Scale	Drawn By LYH	Sheet No. 1/1
--------------	--------------	---------------