

**Recommended PCB Layout**

■ Solder Area □ Component Outline

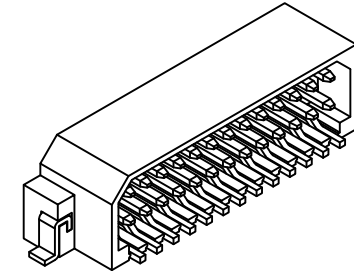

Contacts	Dimensions			
	A	B	C	D
10	4.00	10.25	6.70	8.70
12	5.00	11.25	7.70	9.70
14	6.00	12.25	8.70	10.70
16	7.00	13.25	9.70	11.70
18	8.00	14.25	10.70	12.70
20	9.00	15.25	11.70	13.70
22	10.00	16.25	12.70	14.70
24	11.00	17.25	13.70	15.70
26	12.00	18.25	14.70	16.70
28	13.00	19.25	15.70	17.70
30	14.00	20.25	16.70	18.70

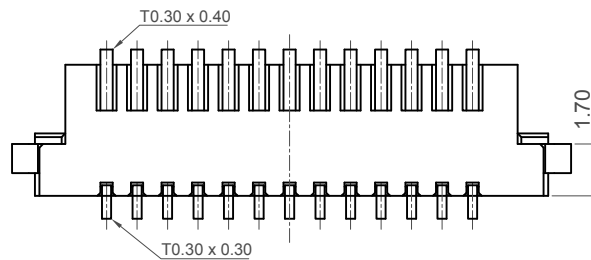
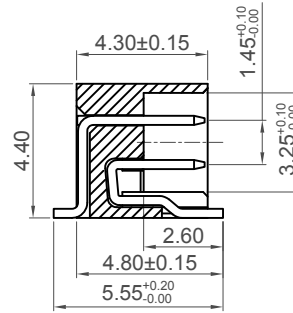
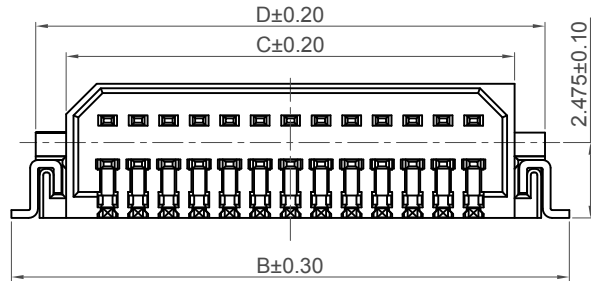

**Specifications**

**Material**

Contact : Copper Alloy  
 Insulator :  
 Standard: Polyamide, Nylon 6T, UL94V-0  
 Option: Polymer, LCP, UL94V-0

**Plating**

See Ordering Grid

**Electrical**

Current Rating : 1 Amp Per Pin  
 Insulation Resistance: 1000 MΩ min  
 Contact Resistance: 20 mΩ max.  
 Dielectric Withstand Voltage: AC 300 V

**Mechanical & Environmental**

Operating Temperature: -40°C to +105°C  
**Soldering Process:**  
 Nylon 6T (Standard)  
 IR Reflow: 260°C for 10 sec.  
 Wave: 230°C for 5-10 sec.  
 Manual Solder: 350°C for 3-5 sec  
 LCP (Option)  
 IR Reflow: 260°C for 10 sec.  
 Wave: 250°C for 5-10 sec.  
 Manual Solder: 350°C for 3-5 sec

Mates with (Subject to pin length)  
 BC061

**Ordering Grid**

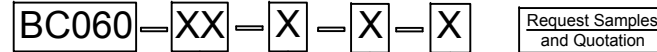

**No. of Contacts**

10 to 30

**Contact Plating**

**A = Gold Flash All Over (Standard)**  
 C = Tin All Over

**Packing Options**

**A = Tape and Reel (Standard)**  
 D = Tube

**Insulator Material**

**N = Nylon 6T (Standard)**  
 L = LCP

Part Number BC060		Product Description 1.00mm Pitch Header, Dual Row, Surface Mount, Horizontal	
Drawing Date 20th May 2008			
By	CC	Tolerances (Except as Noted)	Units: Metric (mm)
Detail	BC060 F PCN	Length X. ± 0.30 X.X ± 0.25 X.XX ± 0.15 X.XXX ± 0.10	Angle X.° ± 5° X.X° ± 3° X.XX° ± 2° X.XXX° ± 1°
Revision	F2	3rd Angle Projection	
Date	28/11/17		
<p>This drawing is confidential and copyright of Global Connector Technology, Ltd (GCT). This drawing must not be copied or disclosed without written consent. E &amp; OE</p>			
		<p>www.gct.co</p>	
Not to Scale	Drawn By ASE	Sheet No. 1/1	

H  
G  
F  
E  
D  
C  
B  
A

1 2 3 4 5 6 7 8