

Recommended PCB Layout
(Tolerance: ±0.05mm)

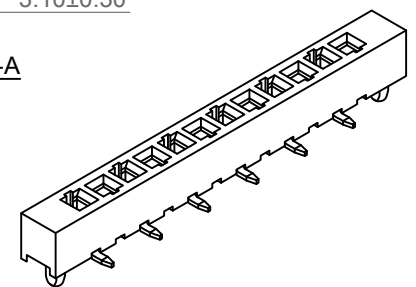
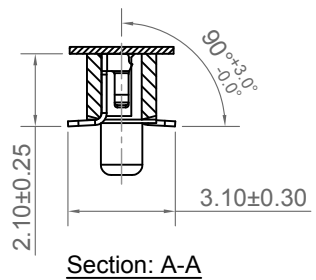

CONTACTS	DIMENSIONS		
	A	B	C
3	2.54	6.99	5.44
4	3.81	8.26	6.71
5	5.08	9.53	7.98
6	6.35	10.80	9.25
7	7.62	12.07	10.52
8	8.89	13.34	11.79
9	10.16	14.61	13.06
10	11.43	15.88	14.33
11	12.70	17.15	15.60
12	13.97	18.42	16.87
13	15.24	19.69	18.14
14	16.51	20.96	19.41
15	17.78	22.23	20.68
16	19.05	23.50	21.95
17	20.32	24.77	23.22
18	21.59	26.04	24.49
19	22.86	27.31	25.76
20	24.13	28.58	27.03
21	25.40	29.85	28.30
22	26.67	31.12	29.57
23	27.94	32.39	30.84
24	29.21	33.66	32.11
25	30.48	34.93	33.38
26	31.75	36.2	34.65
27	33.02	37.47	35.92
28	34.29	38.74	37.19
29	35.56	40.01	38.46
30	36.83	41.28	39.73
31	38.10	42.55	41.00
32	39.37	43.82	42.27
33	40.64	45.09	43.54
34	41.91	46.36	44.81
35	43.18	47.63	46.08
36	44.45	48.9	47.35
37	45.72	50.17	48.62
38	46.99	51.44	49.89
39	48.26	52.71	51.16
40	49.53	53.98	52.43

Specifications 规格

Current Rating 电流额定值: 1 Amp
 Insulation Resistance 绝缘电阻值: 1000 MΩ min.
 Dielectric Withstanding 耐电压: 300 V AC
 Contact Resistance 接触电阻值: 20 mΩ max.
 Operating Temperature 工作温度: -40°C to +105°C
 Contact Material 端子物料: Phosphor Bronze
 Insulation Material 绝缘体物料: Nylon 6T, UL 94V-0

Soldering Process 可焊性: Nylon 6T
 IR Reflow 回流焊: 260°C for 10 sec.
 Manual Solder 人工焊接: 350°C for 3-5 sec.

Mates with 配套之母座
 (Subject to pin length 在端子长度适合的条件下):
 BD020 (0.46mm sq. pin)

Ordering Grid

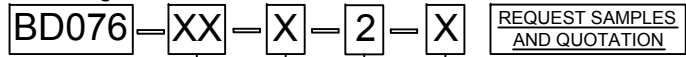

No. of Contacts
03 to 40

Plating Options
A = Gold Flash All Over (Standard)
 C = Tin All Over

Packing
F = Tube with Film (Standard)
 C = Tape and Reel with Film
 D = Tube

Footprint Type
 2 = R2 Type

By	AJO
DETAIL	Drawing Release
REV DATE	A 23/04/14



Tolerances (Except as noted)	Part Number:-	Date:-
Dimensions in mm	BD076	23 APR 14
X ± 0.30 X°±5°	Description:-	
X.X ± 0.20 .X°±3°	1.27mm Pitch Socket, Single Row, Surface Mount, Vertical, Bottom Entry	
X.XX ± 0.15 .XX°±2°	© THIS DRAWING IS CONFIDENTIAL AND MUST NOT BE COPIED OR DISCLOSED WITHOUT WRITTEN CONSENT	
X.XXX ± 0.10 .XXX°±1°	Third Angle Projection	



Scale NTS	Revision A	Material See Note	Drawn by AJO	Sheet No. 1/1
-----------	------------	-------------------	--------------	---------------