

Recommended PCB Layout

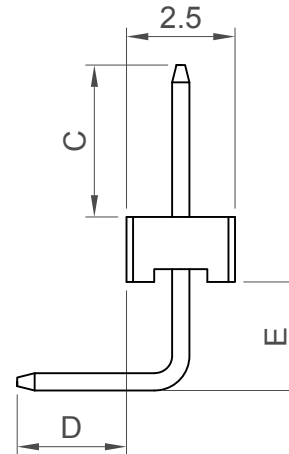
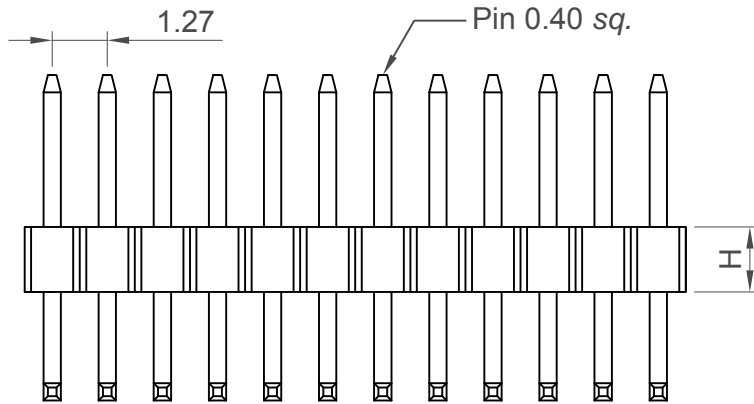
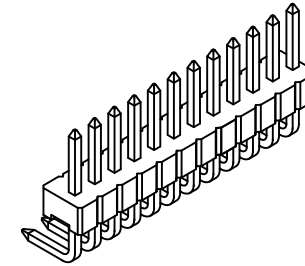

Specifications

Material

Insulator Material:
 Standard: Polymer, LCP, UL 94-V0 (Insulator H=A,B)
 Option: Polyamide, Nylon 6T, UL 94-V0 (Insulator H=K)
 Contact Terminal: Copper Alloy

Plating

See Ordering Grid

Electrical

Current Rating: 1 Amp per pin
 Contact Resistance: 20 mΩ max.
 Insulation Resistance: 1000 MΩ min.
 Dielectric Withstand Voltage: 300 V AC

Mechanical & Environmental

Operating Temperature: -40°C to +105°C
 Soldering Process:

LCP (Standard) -
 IR Reflow: 260°C for 10 sec.
 Wave: 250°C for 5-10 sec
 Manual Solder: 350°C for 3-5 sec
 Nylon 6T (Option) -
 IR Reflow: 260°C for 10 sec.
 Wave: 230°C for 5-10 sec
 Manual Solder: 350°C for 3-5 sec

Mates with (Subject to pin length):

BD074 BD075 BD080 BD090

| Contacts | Dimensions | |
|----------|------------|-------|
| | A | B |
| 2 | 1.27 | 2.54 |
| 3 | 2.54 | 3.81 |
| 4 | 3.81 | 5.08 |
| 5 | 5.08 | 6.35 |
| 6 | 6.35 | 7.62 |
| 7 | 7.62 | 8.89 |
| 8 | 8.89 | 10.16 |
| 9 | 10.16 | 11.43 |
| 10 | 11.43 | 12.70 |
| 11 | 12.70 | 13.97 |
| 12 | 13.97 | 15.24 |
| 13 | 15.24 | 16.51 |
| 14 | 16.51 | 17.78 |
| 15 | 17.78 | 19.05 |
| 16 | 19.05 | 20.32 |
| 17 | 20.32 | 21.59 |
| 18 | 21.59 | 22.86 |
| 19 | 22.86 | 24.13 |
| 20 | 24.13 | 25.40 |
| 21 | 25.40 | 26.67 |
| 22 | 26.67 | 27.94 |
| 23 | 27.94 | 29.21 |
| 24 | 29.21 | 30.48 |
| 25 | 30.48 | 31.75 |
| 26 | 31.75 | 33.02 |
| 27 | 33.02 | 34.29 |
| 28 | 34.29 | 35.56 |
| 29 | 35.56 | 36.83 |
| 30 | 36.83 | 38.10 |
| 31 | 38.10 | 39.37 |
| 32 | 39.37 | 40.64 |
| 33 | 40.64 | 41.91 |

Ordering Grid: **BD110-XX-X-X-XXXX-XXXX-XXXX-X-X** Request Samples and Quotation

No. of Contacts: 02 to 33

Contact Plating:
A = Gold Flash All Over (Standard)
 B = Selective Gold Flash Contact Area/Tin On Tail
 C = Tin All Over
 G = 10µ" Gold Contact Area/Tin On Tail
 I = 30µ" Gold Contact Area/Tin On Tail

Insulator Height "H":
B = 2.00mm (Standard)
 K = 1.00mm
 A = 1.50mm

Dimension C (1/100mm) (Post Height):
0300 = 3.00mm (Standard)
 or specify Dimension C
 eg 0250 = 2.50mm
 (Maximum 0800=8.00mm)
 (Minimum 0100=1.00mm)

Dimension D (1/100mm) (Tail Length):
0230 = 2.30mm (Standard)
 or specify Dimension D
 eg 0250 = 2.50mm
 (Maximum 0500=5.00mm)
 (Minimum 0100=1.00mm)

Dimension E (1/100mm) (Insulator to Pin Bend):
0250 = 2.50mm (Standard)
 or specify Dimension E
 eg 0300 = 3.00mm
 (Maximum 0400=4.00mm)
 (Minimum 0070=0.70mm)

Packing Options:
G = Plastic Box (Standard)
 A = Tape and Reel
 D = Tube

Insulator Material:
L = LCP (Standard) (Insulator H=A,B)
 N = Nylon 6T (Insulator H=K)

| | | | |
|--------------|-------------|--|--|
| Part Number | | Product Description | |
| BD110 | | 1.27mm Pitch Pin Header, Single Row, Through-Hole, Horizontal | |
| Drawing Date | | 28th December 2007 | |
| By | CC | Tolerances (Except as Noted) | Units: |
| Detail | BD110 E PCN | Length: X. ± 0.30 X.X ± 0.20 X.XX ± 0.15 X.XXX ± 0.10 | Angle: X° ± 5° X.X° ± 2° X.XX° ± 1° X.XXX° ± 0.5° |
| Revision | E1 | Metric (mm) | |
| Date | 21/09/17 | | |



www.gct.co

This drawing is confidential and copyright of Global Connector Technology, Ltd (GCT). This drawing must not be copied or disclosed without written consent. E & OE

| | | |
|--------------|--------------|---------------|
| Not to Scale | Drawn By LYH | Sheet No. 1/1 |
|--------------|--------------|---------------|