

TYPE B2
RECOMMENDED PCB LAYOUT

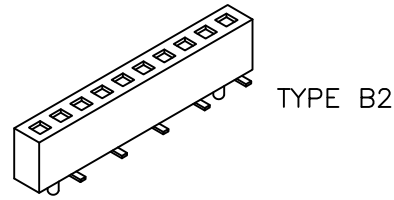

CONTACTS	DIMENSIONS		
	A	B	C
3	4.0	6.6	2.0
4	6.0	8.6	4.0
5	8.0	10.6	6.0
6	10.0	12.6	8.0
7	12.0	14.6	10.0
8	14.0	16.6	12.0
9	16.0	18.6	14.0
10	18.0	20.6	16.0
11	20.0	22.6	18.0
12	22.0	24.6	20.0
13	24.0	26.6	22.0
14	26.0	28.6	24.0
15	28.0	30.6	26.0
16	30.0	32.6	28.0
17	32.0	34.6	30.0
18	34.0	36.6	32.0
19	36.0	38.6	34.0
20	38.0	40.6	36.0
21	40.0	42.6	38.0
22	42.0	44.6	40.0
23	44.0	46.6	42.0
24	46.0	48.6	44.0
25	48.0	50.6	46.0
26	50.0	52.6	48.0
27	52.0	54.6	50.0
28	54.0	56.6	52.0
29	56.0	58.6	54.0
30	58.0	60.6	56.0
31	60.0	62.6	58.0
32	62.0	64.6	60.0
33	64.0	66.6	62.0
34	66.0	68.6	64.0
35	68.0	70.6	66.0
36	70.0	72.6	68.0
37	72.0	74.6	70.0
38	74.0	76.6	72.0
39	76.0	78.6	74.0
40	78.0	80.6	76.0

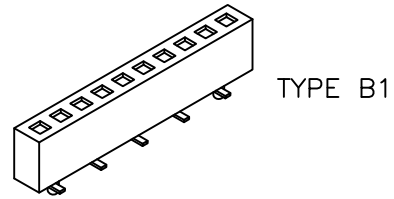
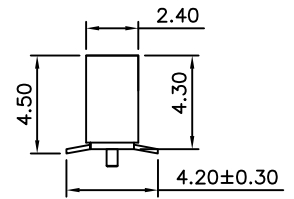
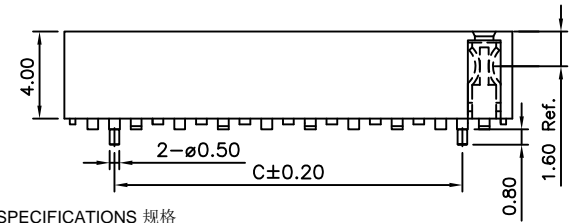

SPECIFICATIONS 规格
 CURRENT RATING 电流额定值: 2 AMP
 INSULATOR RESISTANCE 绝缘电阻值: 1000 MEGOHMS MIN.
 CONTACT RESISTANCE 接触电阻值: 20mOHMS MAX.
 DIELECTRIC WITHSTANDING 耐电压: AC 500 V
 OPERATING TEMPERATURE 工作温度:
 GOLD PLATING: -40°C TO +125°C
 TIN PLATING: -40°C TO +105°C
 CONTACT MATERIAL 端子物料: COPPER ALLOY
 INSULATOR MATERIAL 绝缘体物料:
 STANDARD 标准物料: POLYAMIDE 聚酰胺, NYLON 6T, UL 94-V0
 OPTIONS 可选物料: POLYESTER 聚酯, LCP, UL 94-V0
 SOLDERING PROCESS 可焊性:
 NYLON 6T (STANDARD 标准物料) -
 IR REFLOW 回流焊: 260°C for 10 sec.
 WAVE 波峰焊: 230°C for 5-10 sec.
 MANUAL SOLDER 人工焊接: 350°C for 3-5 sec
 LCP (OPTION 可选物料) -
 IR REFLOW 回流焊: 260°C for 10 sec.
 WAVE 波峰焊: 250°C for 5-10 sec.
 MANUAL SOLDER 人工焊接: 350°C for 3-5 sec

MATES WITH 配套之母座 (SUBJECT TO PIN LENGTH 在端子长度适合的条件下):
 BF020 BF021 BF025 BF035 BF036
 BF040 BF130

By	SA	SA	SA
DETAIL	DRAWING RELEASE	PCB LAYOUT UPDATED	OPERATING TEMP UPDATE
REV DATE	A 19/05/10	B 25/05/10	C 26/08/10

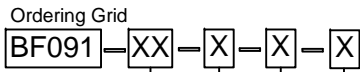

No. of Contacts
 03 to 40

Contact Plating
 A = Gold Flash All Over
 B = Selective Gold Flash Contact Area/
 Tin On Tail
 C = Tin All Over
 G = 10µ" Gold Contact Area/Tin On Tail
 I = 30µ" Gold Contact Area/Tin On Tail
Standard = Gold Flash All Over

Type
 1 = Type B1
 2 = Type B2

Insulator Material
N = Nylon 6T (Standard)
 L = LCP

REQUEST SAMPLES AND QUOTATION

Packing Options
C = Tape and Reel with Film (Standard)
 B = Tape and Reel with Cap
 D = Tube
 E = Tube with Cap
 F = Tube with Film

Tolerances (Except as noted)	Part Number:- BF091	Date:- 19 MAY 10
Dimensions in mm	Description:- 2.0mm PITCH SOCKET, SINGLE ROW, SURFACE MOUNT, DUAL ENTRY, WITH LOCATING PEG	
X. ± 0.30 X. *±5°	© THIS DRAWING IS CONFIDENTIAL AND MUST NOT BE COPIED OR DISCLOSED WITHOUT WRITTEN CONSENT	
XX ± 0.20 X. *±2°	Scale NTS	Revision C
XXX ± 0.15 XXX *±1°	Material See Note	Drawn by SA
XXX ± 0.10 XXX *±0.5°	E & OE	Sheet No. 1/1



GCT

www.globalconnectortechology.com