

Recommended PCB Layout

General Tolerance: ±0.05

▨ Solder Area

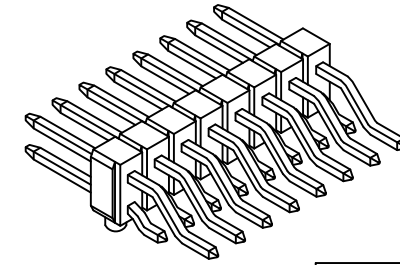

Number of Contacts	Dimensions		
	A	B	C
6	5.08	7.62	2.54
8	7.62	10.16	5.08
10	10.16	12.70	7.62
12	12.70	15.24	10.16
14	15.24	17.78	12.70
16	17.78	20.32	15.24
18	20.32	22.86	17.78
20	22.86	25.40	20.32
22	25.40	27.94	22.86
24	27.94	30.48	25.40
26	30.48	33.02	27.94
28	33.02	35.56	30.48
30	35.56	38.10	33.02
32	38.10	40.64	35.56
34	40.64	43.18	38.10
36	43.18	45.72	40.64
38	45.72	48.26	43.18
40	48.26	50.80	45.72
42	50.80	53.34	48.26
44	53.34	55.88	50.80
46	55.88	58.42	53.34
48	58.42	60.96	55.88
50	60.96	63.50	58.42
52	63.50	66.04	60.96
54	66.04	68.58	63.50
56	68.58	71.12	66.04
58	71.12	73.66	68.58
60	73.66	76.20	71.12

Specifications

Material

Contact: Copper Alloy
 Insulator Material:
 Standard: Polyamide, Nylon 6T, UL 94V-0
 Options: Polymer, LCP, UL 94V-0

Plating

Contact: See Ordering Grid

Electrical

Current Rating: 3 Amp Per Pin
 Insulator Resistance: 1000 MΩ min.
 Contact Resistance: 20 mΩ max.
 Dielectric Withstanding: AC 600 V

Environmental & Mechanical

Operating Temperature: -40°C to +105°C
 Soldering Process:

Nylon 6T (Standard) -
 IR Reflow: 260°C for 10 sec.
 Wave: 230°C for 5-10 sec.
 Manual Solder: 350°C for 3-5 sec.
 LCP (Option) -
 IR Reflow: 260°C for 10 sec.
 Wave: 250°C for 5-10 sec.
 Manual Solder: 350°C for 3-5 sec.

Mates with (Subject to pin length)

BG120 BG140 BG150 BG151 BG160
 BG165 BG170 BG175 BG180 BG185
 BG190 BG195 BG200 BG210 BG225

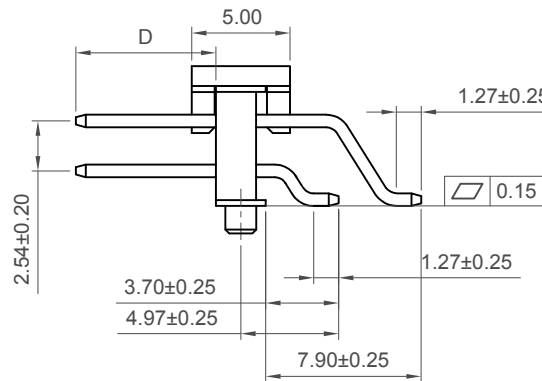
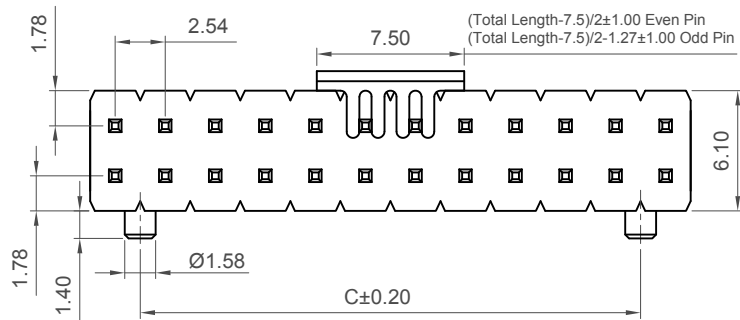

Ordering Grid

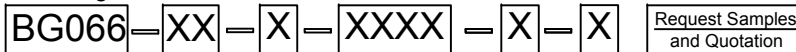

No. of Contacts
06 to 60

Packing Options

B = Tape and Reel with Cap (Standard)
 D = Tube
 E = Tube with Cap

Insulator Materials

N = Nylon 6T (Standard)
 L = LCP

Dimension D (1/100mm) (Post Length)

0710 = 7.10mm (Standard)

Or specify custom Post Length
 eg. 0300 = 3.00mm (Minimum)
 (Maximum 1200 = 12.00mm)

Contact Plating

A = Gold Flash All Over (Standard)
 B = Selective Gold Flash Contact Area/Tin On Tail
 C = Tin All Over
 G = 10µ" Gold Contact Area/Tin On Tail
 I = 30µ" Gold Contact Area/Tin On Tail

Part Number		Product Description	
BG066		2.54mm Pitch Pin Header, Dual Row, Surface Mount, Horizontal, with Post	
Drawing Date		15th June 2009	
By	CC	Tolerances (Except as Noted)	Units:
Detail	BG066 E PCN	Length X. ± 0.30 X.X ± 0.25 X.XX ± 0.15 X.XXX ± 0.10	Metric (mm)
Revision	E1	Angle X.° ± 5° X.X° ± 3° X.XX° ± 2° X.XXX° ± 1°	3rd Angle Projection
Date	10/10/17		



This drawing is confidential and copyright of Global Connector Technology, Ltd (GCT). This drawing must not be copied or disclosed without written consent. E & OE



Not to Scale	Drawn By ASE	Sheet No. 1/1
--------------	--------------	---------------