

Recommended PCB Layout

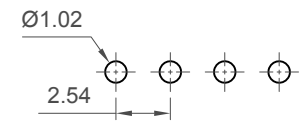

Recommended PCB Layout

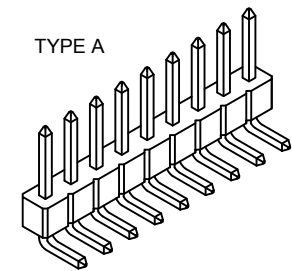

TYPE A

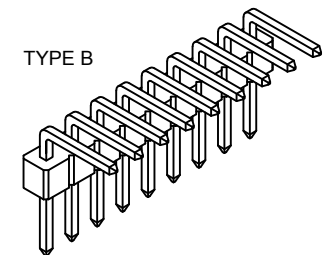

TYPE B

Number of Contacts	Dimensions	
	A	B
2	2.54	5.08
3	5.08	7.62
4	7.62	10.16
5	10.16	12.70
6	12.70	15.24
7	15.24	17.78
8	17.78	20.32
9	20.32	22.86
10	22.86	25.40
11	25.40	27.94
12	27.94	30.48
13	30.48	33.02
14	33.02	35.56
15	35.56	38.10
16	38.10	40.64
17	40.64	43.18
18	43.18	45.72
19	45.72	48.26
20	48.26	50.80
21	50.80	53.34
22	53.34	55.88
23	55.88	58.42
24	58.42	60.96
25	60.96	63.50
26	63.50	66.04
27	66.04	68.58
28	68.58	71.12
29	71.12	73.66
30	73.66	76.20
31	76.20	78.74
32	78.74	81.28
33	81.28	83.82
34	83.82	86.36
35	86.36	88.90
36	88.90	91.44
37	91.44	93.98
38	93.98	96.52
39	96.52	99.06
40	99.06	101.60

Specifications

Material
 Insulator:
 Standard: Polyamide, Nylon 6T, UL 94V-0
 Options: Polymer, LCP, UL 94V-0
 Polyester, PBT, UL 94V-0
 Contact: Copper Alloy

Plating
 See Ordering Grid

Electrical
 Current Rating: 3 Amp Per Pin
 Contact Resistance: 20 mΩ max.
 Insulation Resistance: 1000 MΩ min.
 Dielectric Withstand Voltage: 600 V AC

Mechanical & Environmental
 Operating Temperature: -40°C to +105°C

Soldering Process

Nylon 6T (Standard)
 IR Reflow: 260°C for 10 sec.
 Wave: 230°C for 5-10 sec.
 Manual Solder: 350°C for 3-5 sec

LCP (Option)
 IR Reflow: 260°C for 10 sec.
 Wave: 250°C for 5-10 sec.
 Manual Solder: 350°C for 3-5 sec

PBT (Option) -
 Manual Solder: 330°C for 3-5 sec.
 (Not suitable for hi-temp process)

Mates with (Subject to Pin Length)

BG090 BG095 BG096 BG100 BG110
 BG115 BG125 BG126 BG130 BG135
 BG205

Perfect Planar Mating with

BG145 BG230

Ordering Grid

BG075	XX	X	XXXX	XXXX	XXXX	X	X	Request Samples and Quotation
-------	----	---	------	------	------	---	---	-------------------------------

No. of Contacts: 02 to 40

Contact Plating
 A = Gold Flash All Over (Standard)
 B = Selective Gold Flash Contact Area/Tin On Tail
 C = Tin All Over
 G = 10µ" Gold Contact Area/Tin On Tail
 I = 30µ" Gold Contact Area/Tin On Tail
 L = Matte Tin

Type
 1 = Type A
 2 = Type B

Dimension C (1/100mm) (Post Length)
0600 = 6.00mm (Standard)
 Or specify Custom Post Height
 eg. 0250 = 2.50mm
 (Type A :Maximum 1200 = 12.00mm)
 (Type B :Maximum 0700 = 7.00mm)
 (Type A :Minimum 0100 = 1.00mm)
 (Type B :Minimum 0257 = 2.57mm)

Dimension D (1/100mm) (Tail Length)
0300 = 3.00mm (Standard)
 Or specify Custom Footprint Width
 eg. 0250 = 2.50mm
 (Type A :Maximum 0700 = 7.00mm)
 (Type B :Maximum 1200 = 12.00mm)
 (Type A&B :Minimum 0100 = 1.00mm)

Insulator Material
 N = Nylon 6T (Standard)
 L = LCP
 P = PBT

Dimension E (1/100mm)
 (Bottom of insulator to Pin Centre)
Type A: 0150 = 1.50mm (Standard)
Type B: 0480 = 4.80mm (Standard)
 Or specify Dimension E
 eg. 0250 = 2.50mm
 (Type A :Maximum 0245 = 2.45mm)
 (Type A :Minimum 0032 = 0.32mm)
 (Type B :Maximum 0500 = 5.00mm)
 (Type B :Minimum 0286 = 2.86mm)

Packing Options
 G = Plastic Box (Standard)
 D = Tube
 E = Tube with Cap

Part Number		Product Description	
BG075		2.54mm Pitch Pin Header, Single Row, Through-Hole, Horizontal	
Drawing Date		1st November 2006	
By	CC	Tolerances (Except as Noted)	Units:
Detail	BG075 D PCN	Length: X. ± 0.30 X.X ± 0.20 X.XX ± 0.15 X.XXX ± 0.10	Metric (mm)
Revision	D4	Angle: X.° ± 5° X.X° ± 2° X.XX° ± 1° X.XXX° ± 0.5°	3rd Angle Projection
Date	22/10/19		



This drawing is confidential and copyright of Global Connector Technology, Ltd (GCT). This drawing must not be copied or disclosed without written consent. E & OE



www.gct.co

Not to Scale	Drawn By LYH	Sheet No. 1/1
--------------	--------------	---------------

H
G
F
E
D
C
B
A

1 2 3 4 5 6 7 8