

H  
G  
F  
E  
D  
C  
B  
A

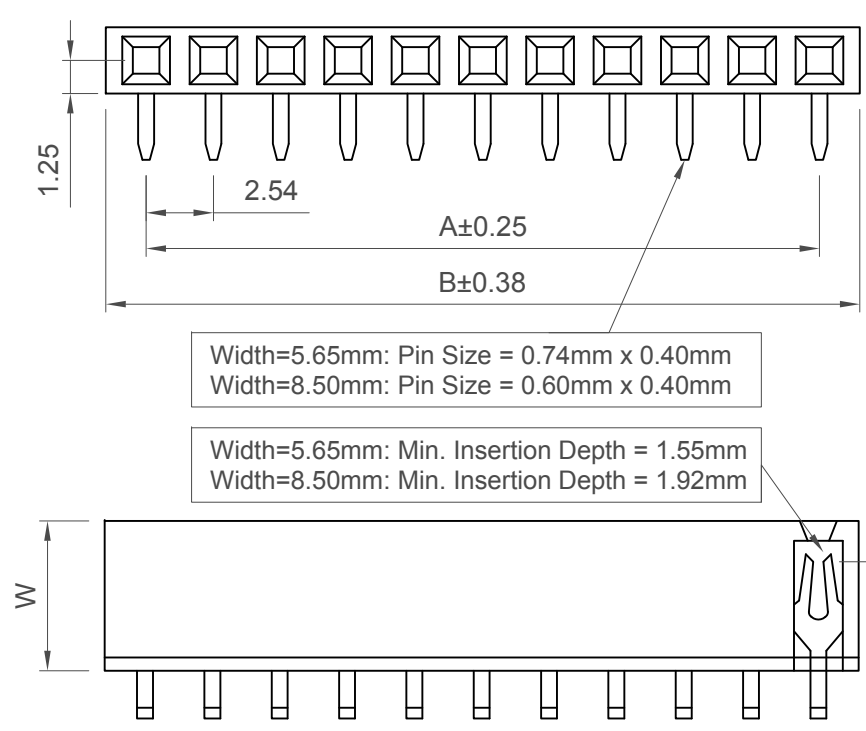

Width=5.65mm: Pin Size = 0.74mm x 0.40mm  
Width=8.50mm: Pin Size = 0.60mm x 0.40mm

Width=5.65mm: Min. Insertion Depth = 1.55mm  
Width=8.50mm: Min. Insertion Depth = 1.92mm

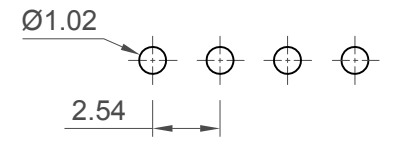

Recommended PCB Layout

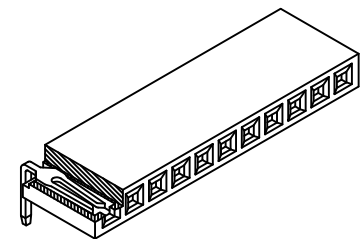

Specifications 规格

**Material 物料**  
Contact Material 端子物料: Copper Alloy  
Insulator Material 绝缘体物料:  
Standard 标准物料: Polyamide 聚酰胺, Nylon 6T, UL 94V-0  
Options 可选物料: Polymer 聚合物, LCP, UL 94V-0  
Polyester 聚酯, PBT, UL94-V0

**Plating 电镀**  
Contact 接触: See Ordering Grid

**Electrical 电气**  
Current Rating 电流额定值: 3 Amp Per Pin  
Insulator Resistance 绝缘电阻值: 1000 MΩ min.  
Dielectric Withstanding 耐电压: AC 600 V  
Contact Resistance 接触电阻值: 20mΩ max.

**Mechanical & Environmental 机械 & 环境**  
Operating Temperature 工作温度: -40°C to +105°C  
Soldering Process 可焊性:

Nylon 6T (Standard 标准物料) -  
IR Reflow 回流焊: 260°C for 10 sec.  
Wave 波峰焊: 230°C for 5-10 sec.  
Manual Solder 人工焊接: 350°C for 3-5 sec  
PBT (Option 可选物料) -  
Manual Solder 人工焊接: 330°C for 3-5 sec.  
(Not suitable for hi-temp process 不适合制程)  
LCP (Option 可选物料) -  
IR Reflow 回流焊: 260°C for 10 sec.  
Wave 波峰焊: 250°C for 5-10 sec.  
Manual Solder 人工焊接: 350°C for 3-5 sec

Mates with 配套之母座  
(Subject to pin length 在端子长度适合的条件下):  
BG020 BG030 BG031 BG035  
BG055 BG060  
Perfect Planar Mating with  
BG075 BG080

No. of Contacts	Dimensions	
	A	B
2	2.54	5.58
3	5.08	8.12
4	7.62	10.66
5	10.16	13.20
6	12.70	15.74
7	15.24	18.28
8	17.78	20.82
9	20.32	23.36
10	22.86	25.90
11	25.40	28.44
12	27.94	30.98
13	30.48	33.52
14	33.02	36.06
15	35.56	38.60
16	38.10	41.14
17	40.64	43.68
18	43.18	46.22
19	45.72	48.76
20	48.26	51.30
21	50.80	53.84
22	53.34	56.38
23	55.88	58.92
24	58.42	61.46
25	60.96	64.00
26	63.50	66.54
27	66.04	69.08
28	68.58	71.62
29	71.12	74.16
30	73.66	76.70
31	76.20	79.24
32	78.74	81.78
33	81.28	84.32
34	83.82	86.86
35	86.36	89.40
36	88.90	91.94
37	91.44	94.48
38	93.98	97.02
39	96.52	99.56
40	99.06	102.10

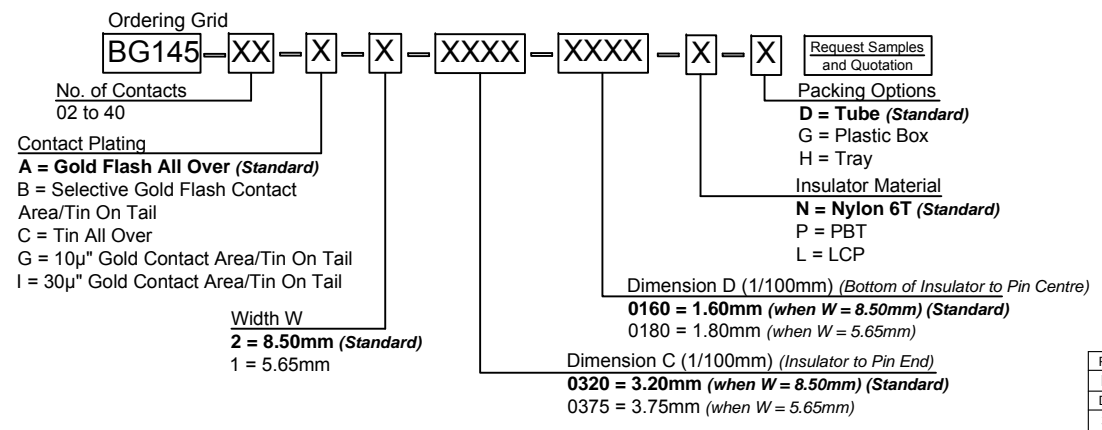

**Ordering Grid**  
BG145-XX-X-X-XXXX-XXXX-X-X

No. of Contacts  
02 to 40

Contact Plating  
A = Gold Flash All Over (Standard)  
B = Selective Gold Flash Contact Area/Tin On Tail  
C = Tin All Over  
G = 10µ" Gold Contact Area/Tin On Tail  
I = 30µ" Gold Contact Area/Tin On Tail

Width W  
2 = 8.50mm (Standard)  
1 = 5.65mm

Packing Options  
D = Tube (Standard)  
G = Plastic Box  
H = Tray

Insulator Material  
N = Nylon 6T (Standard)  
P = PBT  
L = LCP

Dimension D (1/100mm) (Bottom of Insulator to Pin Centre)  
0160 = 1.60mm (when W = 8.50mm) (Standard)  
0180 = 1.80mm (when W = 5.65mm)

Dimension C (1/100mm) (Insulator to Pin End)  
0320 = 3.20mm (when W = 8.50mm) (Standard)  
0375 = 3.75mm (when W = 5.65mm)

Part Number BG145		Product Description 2.54mm Pitch Socket Single Row, Through-Hole, Horizontal	
Drawing Date 30th October 2006			
By CC	Tolerances (Except as Noted)	Units: Metric (mm)	<p>This drawing is confidential and copyright of Global Connector Technology, Ltd (GCT). This drawing must not be copied or disclosed without written consent. E &amp; OE</p>
Detail BG145 G PCN	Length X. ± 0.30 X.X ± 0.20 X.XX ± 0.15 X.XXX ± 0.10	Angle X° ± 5° X.X° ± 2° X.XX° ± 1° X.XXX° ± 0.5°	
Revision G1			
Date 21/04/17			

**GCT**  
Global Connector Technology  
www.gct.co

Not to Scale	Drawn By LYH	Sheet No. 1/1
--------------	-----------------	------------------