

H  
G  
F  
E  
D  
C  
B  
A

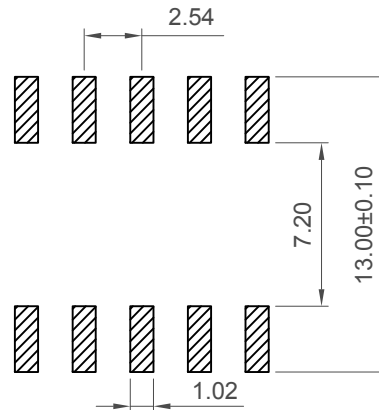

Recommended PCB Layout

▨ Solder Area

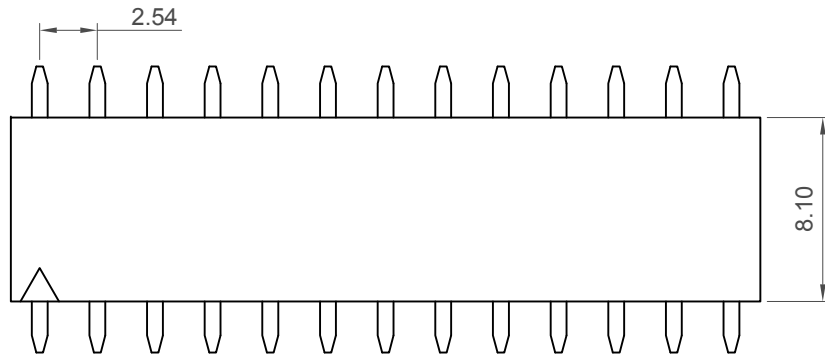
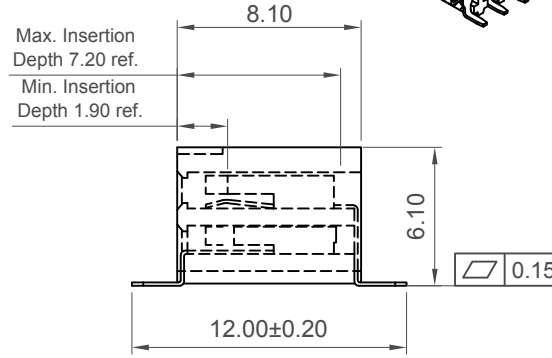
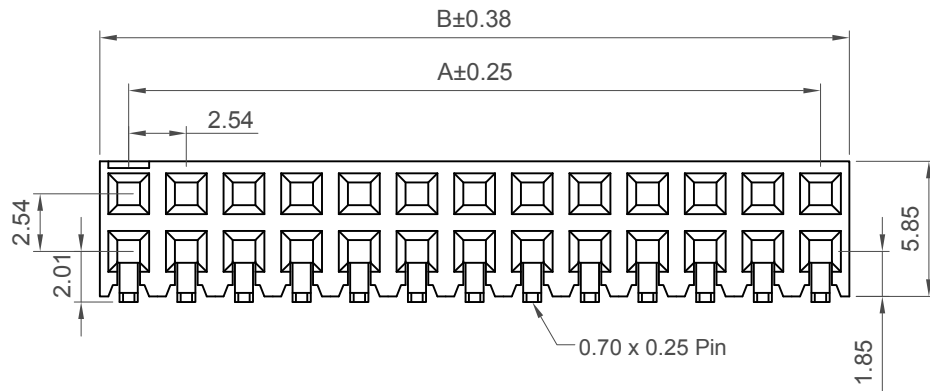
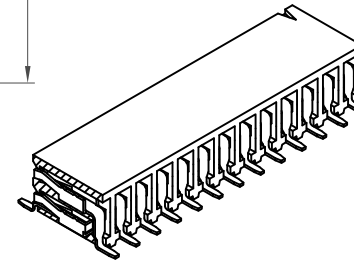

No. of Contacts	Dimension	
	A	B
4	2.54	5.08
6	5.08	7.62
8	7.62	10.16
10	10.16	12.70
12	12.70	15.24
14	15.24	17.78
16	17.78	20.32
18	20.32	22.86
20	22.86	25.40
22	25.40	27.94
24	27.94	30.48
26	30.48	33.02
28	33.02	35.56
30	35.56	38.10
32	38.10	40.64
34	40.64	43.18
36	43.18	45.72
38	45.72	48.26
40	48.26	50.80
42	50.80	53.34
44	53.34	55.88
46	55.88	58.42
48	58.42	60.96
50	60.96	63.50
52	63.50	66.04
54	66.04	68.58
56	68.58	71.12
58	71.12	73.66
60	73.66	76.20
62	76.20	78.74
64	78.74	81.28
66	81.28	83.82
68	83.82	86.36
70	86.36	88.90
72	88.90	91.44
74	91.44	93.98
76	93.98	96.52
78	96.52	99.06
80	99.06	101.60

Specifications

**Material**  
 Contact: Copper Alloy  
 Insulator Material:  
 Standard: Polyamide, Nylon 6T, UL 94V-0  
 Options: Polymer, LCP, UL 94V-0

**Plating**  
 See Ordering Grid

**Electrical**  
 Current Rating: 3 Amp per pin  
 Insulator Resistance: 1000 MΩ min.  
 Contact Resistanc: 20 mΩ max.  
 Dielectric Withstanding: AC 600 V

**Environmental & Mechanical**  
 Operating Temperature: -40° to +105°C  
 Soldering Process:  
 Nylon 6T (Standard) -  
 IR Reflow: 260°C for 10 sec.  
 Wave: 230°C for 5-10 sec.  
 Manual Solder: 350°C for 3-5 sec

LCP (Option) -  
 IR Reflow: 260°C for 10 sec.  
 Wave: 250°C for 5-10 sec.  
 Manual Solder: 350°C for 3-5 sec

Mates with (Subject to pin length)  
 BG025 BG040 BG041 BG045  
 BG050 BG065 BG066 BG070  
 BG085

Ordering Grid

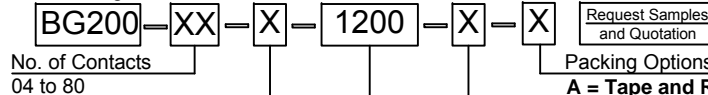

**Contact Plating**  
**A = Gold Flash All Over (Standard)**  
 B = Selective Gold Flash Contact Area/Tin On Tail  
 C = Tin All Over  
 G = 10µ" Gold Contact Area/Tin On Tail  
 I = 30µ" Gold Contact Area/Tin On Tail

**Packing Options**  
**A = Tape and Reel (Standard)**  
 D = Tube

**Insulator Material**  
**N = Nylon 6T (Standard)**  
 L = LCP

**Footprint Width (1/100mm)**  
 1200 = 12.00mm

Part Number		Product Description	
BG200		2.54mm Pitch Socket	
Drawing Date		Dual Row, Surface Mount, Horizontal	
30th October 2006			
By	CC	Tolerances (Except as Noted)	Units:
Detail	BG200 E PCN	Length X ± 0.30 X.X ± 0.20 X.XX ± 0.15 X.XXX ± 0.10	Metric (mm)
Revision	E2	Angle X° ± 5° X.X° ± 2° X.XX° ± 1° X.XXX° ± 0.5°	3rd Angle Projection
Date	28/11/17		



This drawing is confidential and copyright of Global Connector Technology, Ltd (GCT). This drawing must not be copied or disclosed without written consent. E & OE



Not to Scale | Drawn By LYH | Sheet No. 1/1