

Recommended PCB Layout  
(Tolerance:  $\pm 0.05$ )

■ Solder Area

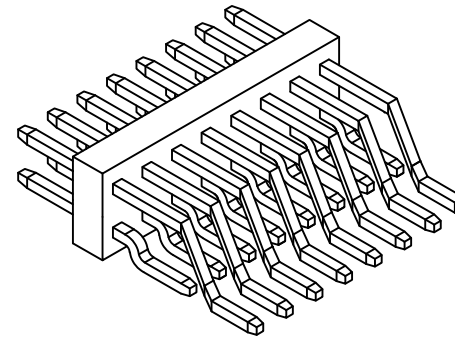

Contacts	Dimensions	
	A	B
4	1.00	2.20
6	2.00	3.20
8	3.00	4.20
10	4.00	5.20
12	5.00	6.20
14	6.00	7.20
16	7.00	8.20
18	8.00	9.20
20	9.00	10.20
22	10.00	11.20
24	11.00	12.20
26	12.00	13.20
28	13.00	14.20
30	14.00	15.20

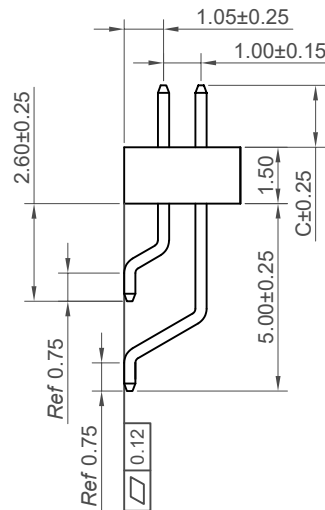
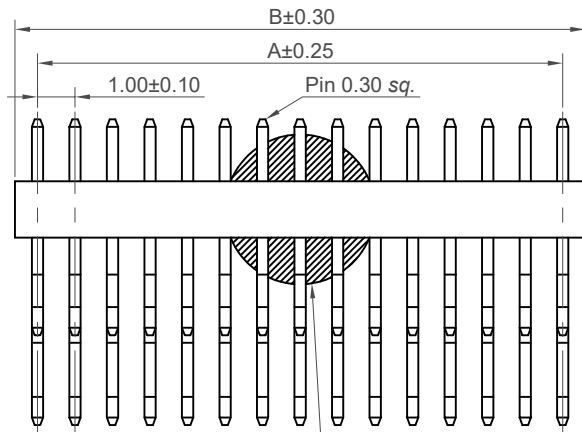

Film  $\varnothing = 3.00\text{mm}$  (04-06 Contacts)  
 $\varnothing = 4.00\text{mm}$  (08-30 Contacts)  
 Thickness = 0.15mm (All)

Specifications

Material

Insulator: Polymer LCP, UL94V-0  
 Contact: Copper Alloy

Plating

Gold Flash All Over

Electrical

Current Rating: 1 Amp per pin  
 Contact Resistance: 20 m $\Omega$  max.  
 Insulating Resistance: 1000 M $\Omega$  min.  
 Dielectric Withstand Voltage: 300V AC

Mechanical & Environmental

Operating Temperature: -40°C to +105°C  
 Soldering Process:  
 IR Reflow: 260°C for 10 sec.  
 Wave: 250°C for 5-10 sec  
 Manual Solder: 350°C for 3-5 sec

Mates with (Subject to pin length)  
 BC084 BC085

Ordering Grid

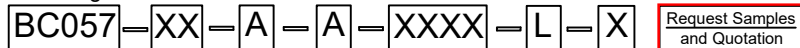

No. of Contacts  
04 to 30

Contact Plating  
A = Gold Flash All Over (Standard)

Insulator Width  
A = 1.50mm

Packing Options  
C = Tape & Reel with Film (04-30 contacts)

Insulator Material  
L = LCP (Standard)

Dimension C (1/100mm) (Post Height)  
 0150 = 1.50mm (Standard)  
 or specify Dimension C  
 eg 0250 = 2.50mm  
 (Maximum 0600=6.00mm)  
 (Minimum 0100=1.00mm)

Part Number		Product Description	
BC057		1.0mm Pitch Pin Header, Dual Row, Surface Mount, Horizontal	
Drawing Date		9th September 2009	
By	KY	Tolerances (Except as Noted)	Units:
Detail	BC057 I PCN	Length: X. ± 0.30 Angle: X.X ± 0.25 X.XX ± 0.15 X.XXX ± 0.10	Metric (mm)
Revision	I3	X.X° ± 5° X.XX° ± 3° X.XXX° ± 2° X.XXX° ± 1°	3rd Angle Projection
Date	21/06/24		



This drawing is confidential and copyright of Global Connector Technology, Ltd (GCT). This drawing must not be copied or disclosed without written consent. E & OE



Not to Scale | Drawn By ASE | Sheet No. 1/1