

# USB 125

Product Release



## GCT

Short Body Shell  
USB Type A Receptacle

[www.gct.co](http://www.gct.co)

# Vital Stats

**USB1125** is a USB Type A receptacle with a short body shell depth and a 25% smaller footprint area than standard USB-A connector products.

USB

**Type A**

Shell Depth

**10.0mm**

PCB Footprint

**131mm<sup>2</sup>**

Mating Cycles

**5,000**

USB Specification

**2.0**

Shell

**Stainless Steel**

Tested to 5,000 mating cycles, the 6 shell retention tabs perform to a higher durability standard, and with a 3A current rating, this connector is small in size with no compromise on performance.

- -30°C to +85°C operating temperature.
- Gold plated contacts.
- Supplied in stacked tray packaging (100 pcs per tray, 25 trays per carton).

## USB1125 depth dimensions vs other GCT USB variants

### USB1046

- USB Type A 2.0
- 13.4mm shell depth
- 175.5mm<sup>2</sup> PCB footprint

### USB1125

- USB Type A 2.0
- 10mm shell depth
- 131.0mm<sup>2</sup> PCB footprint

### USB4110

- USB Type C 2.0
- 7.35mm shell depth
- 70.5mm<sup>2</sup> PCB footprint



# Plan View

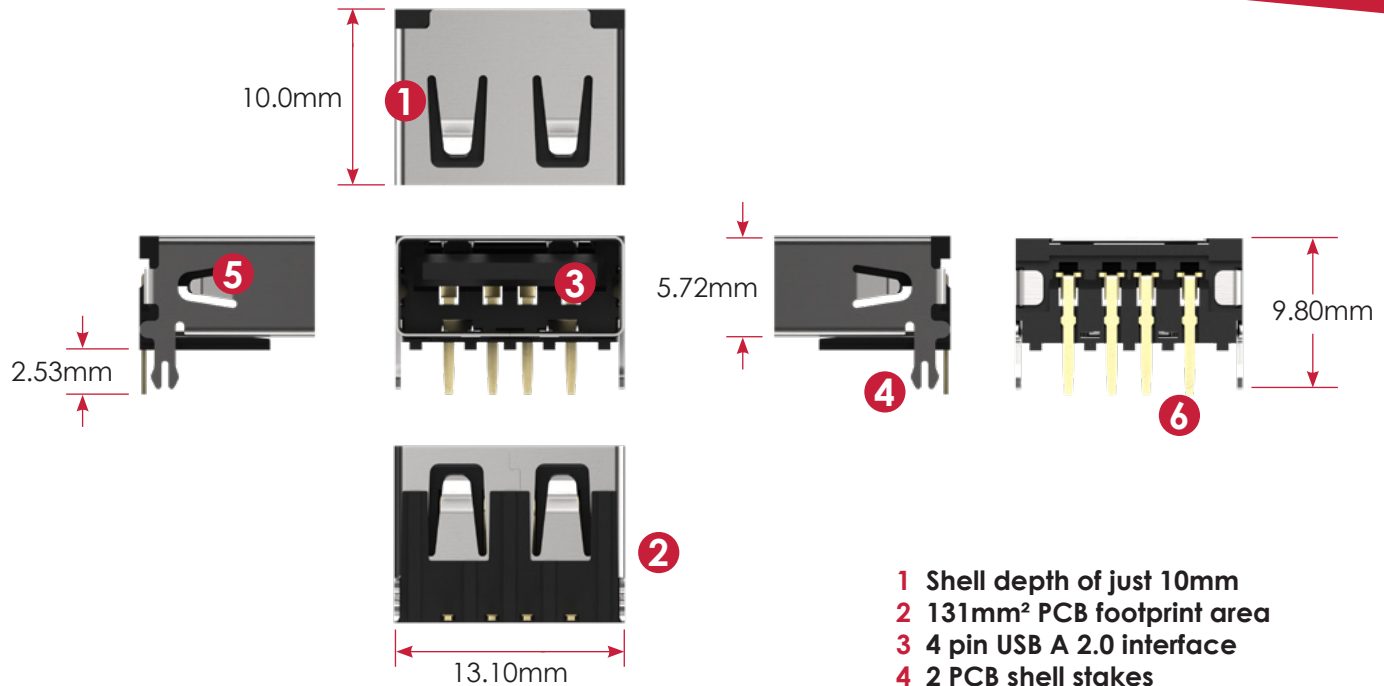

[gct.co/connector/usb1125](http://gct.co/connector/usb1125)

- 1** Shell depth of just 10mm
- 2** 131mm<sup>2</sup> PCB footprint area
- 3** 4 pin USB A 2.0 interface
- 4** 2 PCB shell stakes
- 5** 6 shell retention tabs
- 6** 4 through-hole solder tails

# Short Body USB Products



## USB3160

- Micro Type-B USB 2.0 vertical receptacle
- 5.30mm shell depth (profile above PCB)
- SMT solder tails & through-hole shell stakes



## USB4060 / 4065

- Type-C USB 3.1 horizontal receptacle
- 8.65mm shell depth
- Mid mount (4060) and top mount (4065) versions



## USB1115

- Type-A USB 3.0 horizontal receptacle
- 12.5mm (overall)/ 10.0mm (cutaway side) shell depth
- 5,000 mating cycles

Short body USB solutions at [gct.co](http://gct.co)

